

▼ From left to right: P-142ALSS, P-392ALSS, V-152NV, V-66NV, RC-256NV, RC-106NV, RC-53NV



Cylinders

- Nickel-plated steel
- Viton® seals provide heat and chemical resistance
- Single-acting, spring return
- Collar thread, plunger thread and base mounting holes
- Plunger wiper reduces contamination, extends cylinder life

Hand Pumps

- Viton® seals provide heat and chemical resistance
- Anodized aluminium pump reservoirs and plastic encapsulated pump bodies
- Stainless steel pump pistons and inserts will not corrode or rust
- Second handle on P-142ALSS for two hand use
- Internal pressure relief valve for overload protection
- Handles lock for easy carrying

Pressure Relief and Check Valve

- Nickel-plated steel
- Viton® seals provide heat and chemical resistance
- Check valve V-66NV for load holding
- Pressure relief valve V-152NV limits pressure in hydraulic circuit

Solutions for maximum corrosion resistance in extreme environments



Applications

For use in wet environments such as food processing, pulp and paper, mining, construction and applications in high temperature or in welding areas.



Aluminium Cylinders

If you need a higher cylinder capacity-to-weight-ratio the lightweight RAC-Series are the perfect choice.

Page: 14



Hoses

Enerpac offers a complete line of high quality hydraulic hoses. To ensure the integrity of your system, specify only Enerpac hydraulic hoses.

Page: 122



Stainless Steel Gauge

Minimize the risk of overloading and ensure long, dependable service from your equipment. The alloy steel gauge T6003L is the perfect choice.

Page: 132

High Temperature & Corrosion Resistant Products

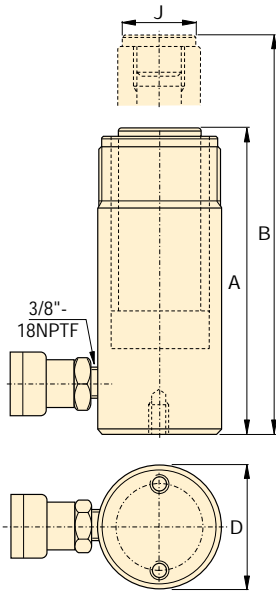

RC-Series

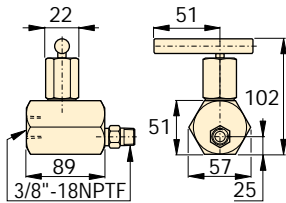

V-66NV

Release valve

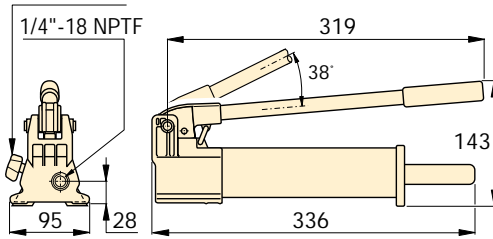

P-142ALSS

Release valve

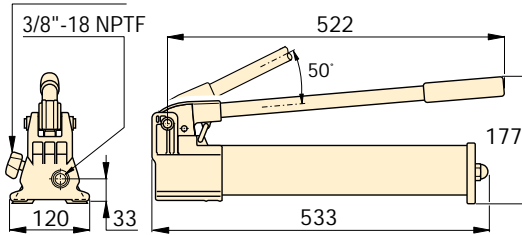

P-392ALSS

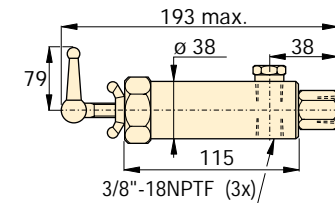

V-152NV

**RC
P
V
Series**



Cylinder Capacity:

5 - 25 ton

Stroke:

54 - 158 mm

Maximum Operating Pressure:

700 bar



Multifluid Hand Pumps

MP-Series corrosion resistant hand pumps for low pressure filling and high pressure testing

applications, suitable for a wide range of fluids.

Page: 74

Single-Acting Cylinders

Cylinder Capacity at 700 bar ton (kN)	Stroke (mm)	Model Number ¹⁾	Cylinder Effective Area (cm ²)	Oil Capacity (cm ³)	Collapsed Height A (mm)	Extended Height B (mm)	Outside Diameter D (mm)	Saddle Diameter J (mm)	 (kg)
5 (45)	76	RC-53NV	6,5	50	165	241	38	25	1,5
10 (101)	54	RC-102NV	14,5	78	121	175	57	57	2,3
	156	RC-106NV	14,5	226	247	403	57	57	4,4
25 (232)	158	RC-256NV	33,2	525	273	431	85	85	10,0

¹⁾ For more dimensional information see page 10.



Two-Speed Hand Pumps

Pump Type	Usable Oil Capacity (cm ³)	Model Number ¹⁾	Pressure Rating (bar)		Oil Displacement per stroke (cm ³)		Max. Handle Effort (kg)	Piston Stroke (mm)	 (kg)
			1st stage	2st stage	1st stage	2st stage			
Two Speed	327	P-142ALSS	13	700	3,62	0,90	35,4	12,7	2,1
	901	P-392ALSS	13	700	11,26	2,47	42,2	25,4	4,1

¹⁾ For more hand pump information see page 68.



Manual Valves

Valve Type	Model Number ¹⁾	Valve Function	 (kg)
Manual Check Valve	V-66NV	Load holding with cylinders	1,8
Pressure Relief Valve	V-152NV	Limits pressure in system, adjustment range 55 - 700 bar	1,6

¹⁾ For more information see page 140.

